

APPLICATION REQUIREMENTS:

Replacement of a Left Hand Disconnect Assembly and/or its components for a Model H or HJ Operator.

PACKING LIST:

ITEM	PART NUMBER	DESCRIPTION	QUANTITY
1	10-10707	Disconnect Support Bracket	1
2	10-10708	Yoke	1
3	10-10875	Disconnect Lever	1
4	10-10898-L	Interlock Switch Actuator	1
5	11-10878	Disconnect Shaft	1
6	19-8A-12	12 ft. Of Sash Chain	1
7	82-HN25-12	1/4-20 x 3/4 HEX HD CAP Screw	2
8	82-SH10-14	Screw 10-32 x 7/8"	2
9	84-FN-10	Serrated Flange Nut, #10-32	2
10	84-FN-25	Nut, 1/4-20 Serrated Flange	2
11	86-RP04-100	Roll Pin 1/8 x 1"	2
12	82-WS08-06T	Screw 8-32 x 3/8" slot	1
13	86-CP05-108	Cotterpin 5/32" x 1 1/2"	1
14	18-11007	Spring 2 1/2" x .312"	1

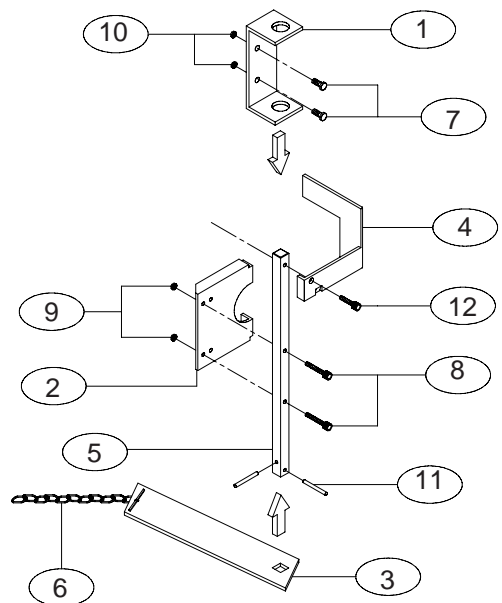
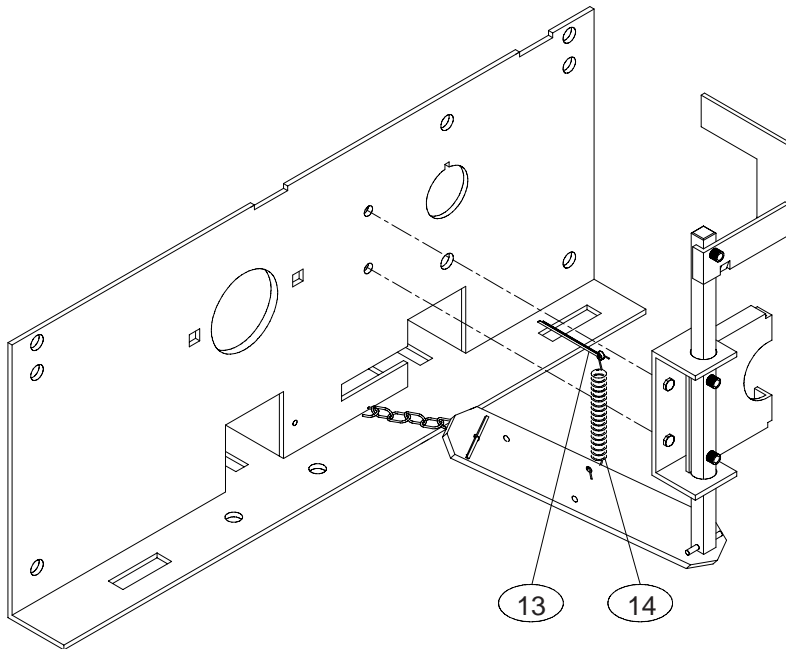

INSTALLATION INSTRUCTIONS



WARNING

DISCONNECT POWER AT THE FUSE BOX BEFORE PROCEEDING. IF NECESSARY REMOVE THE OPERATOR FROM ITS MOUNTED POSITION.

NOTE: Refer to the Owner's Manual supplied with the operator for all mounting and wiring instructions.

REMOVE EXISTING ASSEMBLY:

Remove the two rollpins holding the disconnect lever in

place. Remove the two 10-32 screws attaching the yoke to the disconnect shaft. Remove the yoke and set it aside. Slide the disconnect shaft up and out of the disconnect support bracket. Remove the disconnect lever and chain from the Motor Frame. Remove the disconnect support bracket by removing the two 1/4-20 cap screws.

INSTALLING NEW ASSEMBLY:

Attach the interlock switch actuator to the disconnect shaft with a 10-32 screw. To complete the installation, follow the steps outlined above in the reverse order, referring to the illustration and the Owner's Manual if necessary. Restoring power completes the installation.